

1. Click on the Classwork Tab at the bottom.

2. Select the work that you need to do.

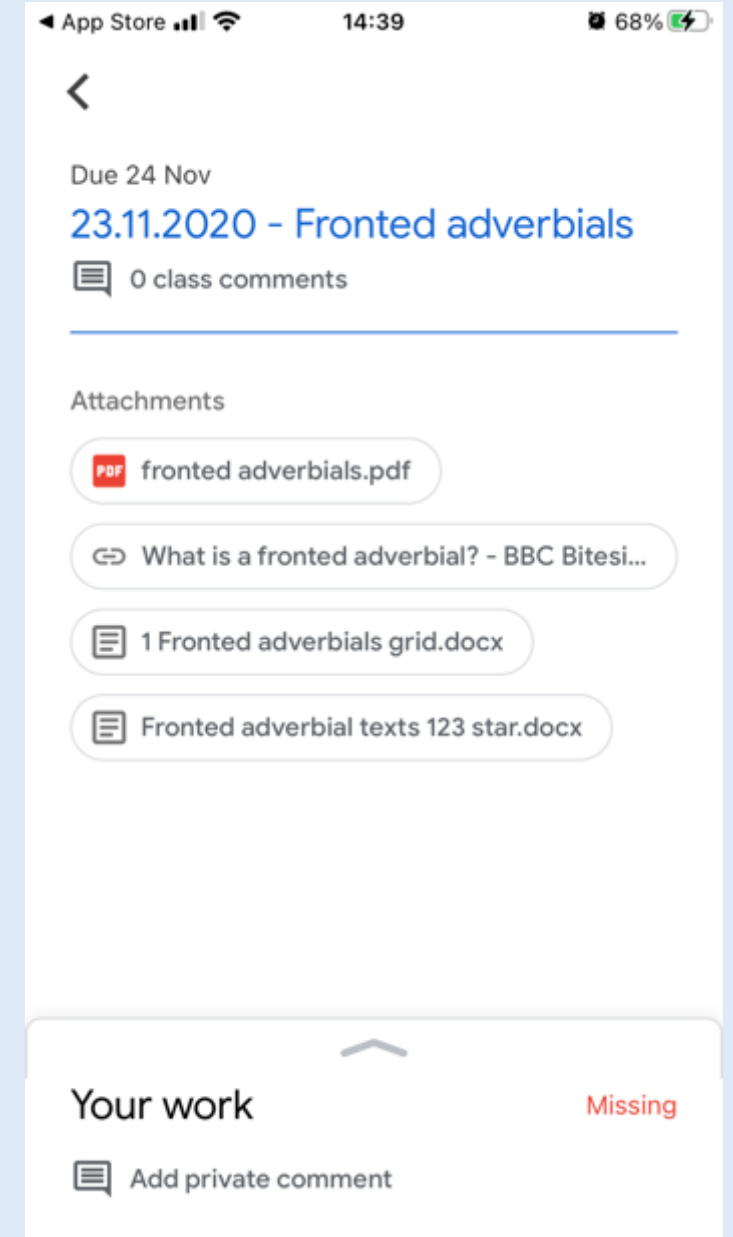

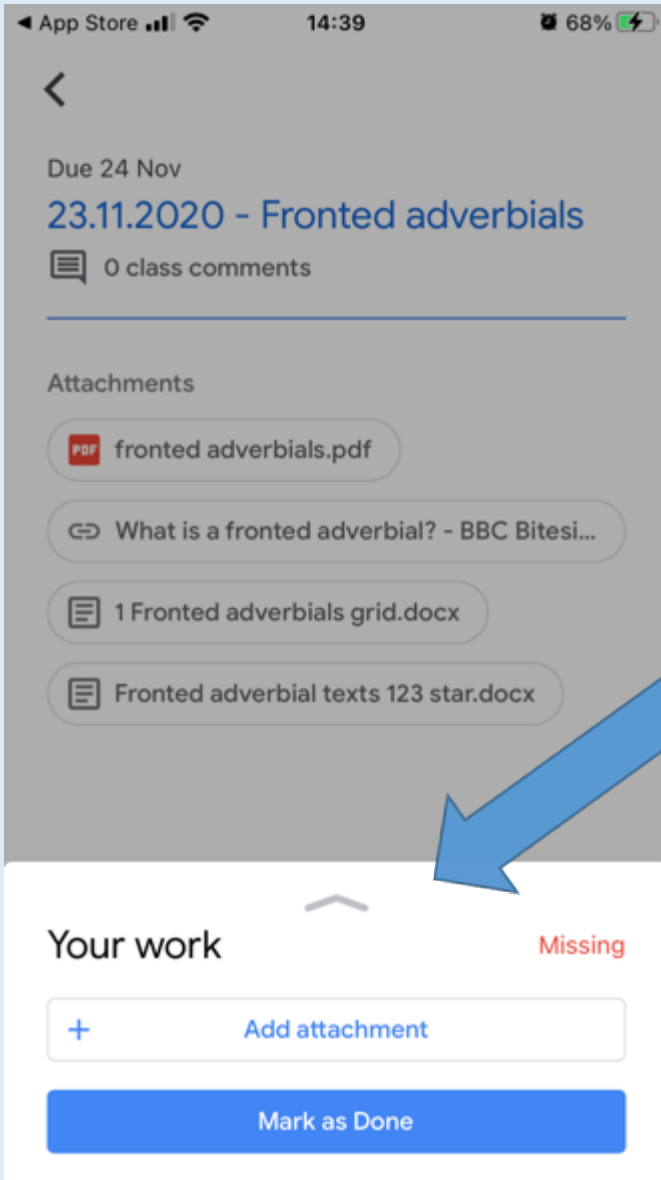

3. Click on the arrow at the bottom next to Your Work

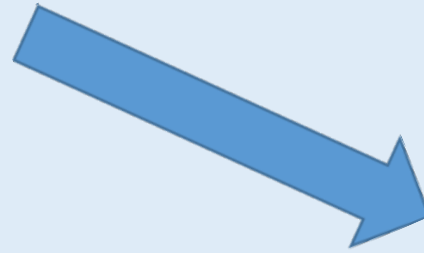

4. It opens up a page like this. Click on + Add attachment tab

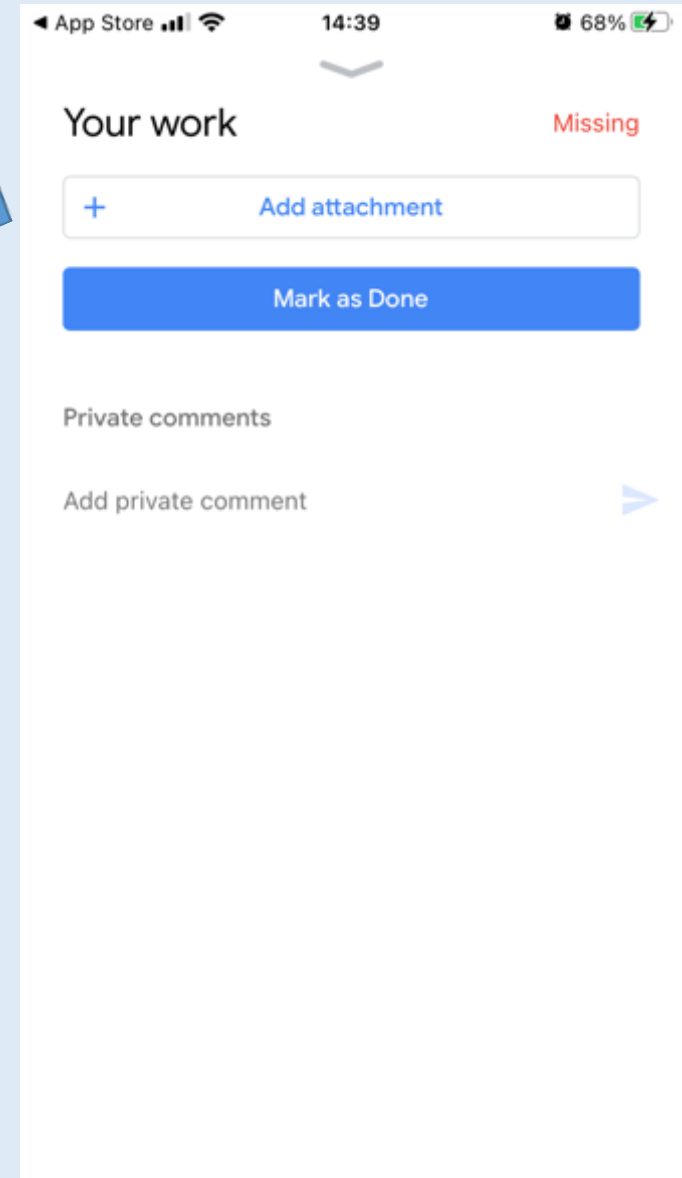

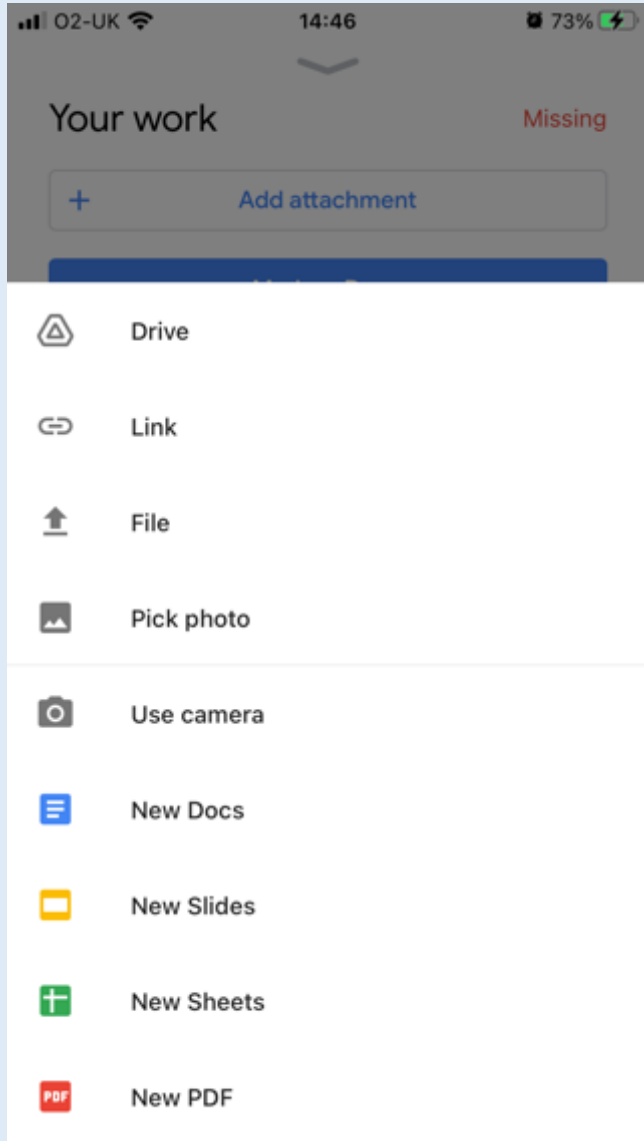

5. It opens up a page like this. Either take a photo of your work with your phone/iPad or select add file and find where you have saved the file previously.

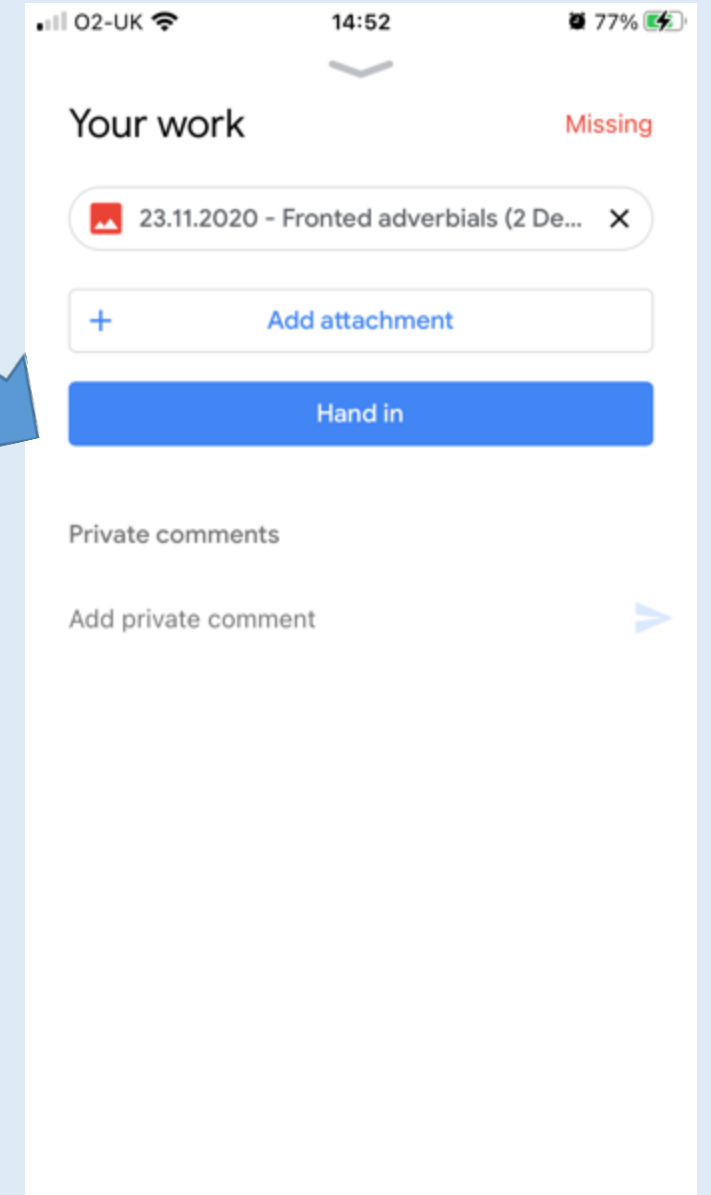

6. When you've uploaded the image, click on Hand In.